

Montage Instructie

LEEN BAKKER, 4941 SH 3, THE NETHERLANDS

Artikel Nr.:12301660, 12301665, 12301670

NL: Max. draagvermogen 120kg

DE: Maximale Tragfähigkeit 120kg

FR: Poids maximum 120kg

EN: Max. carrying capacity 120kg

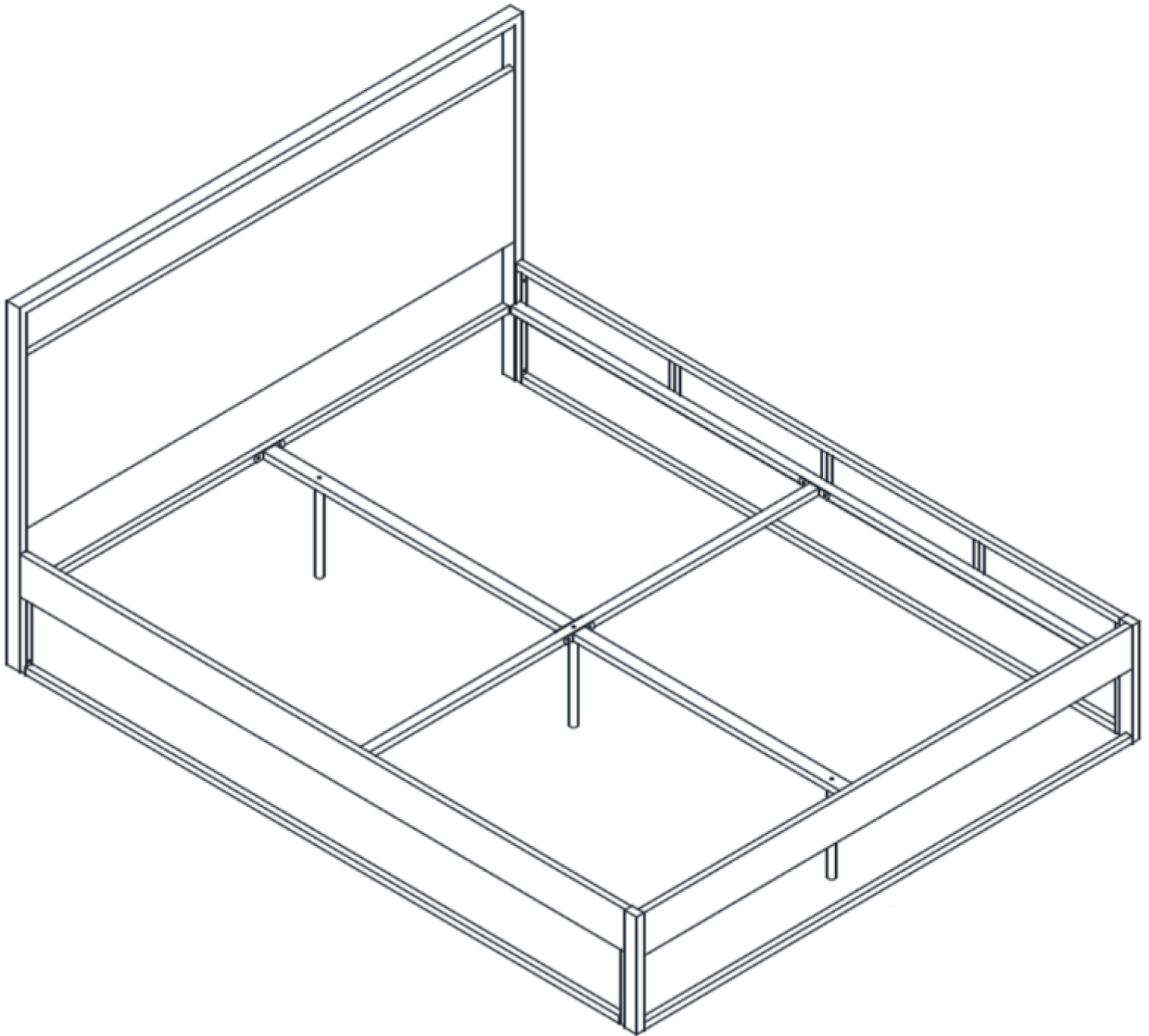

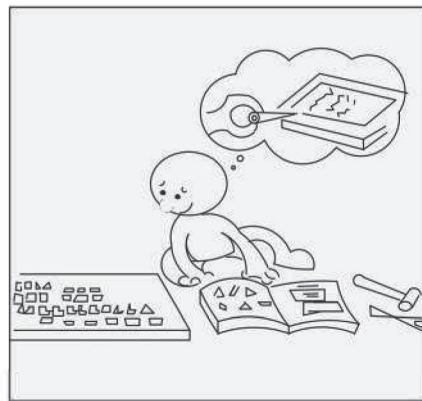
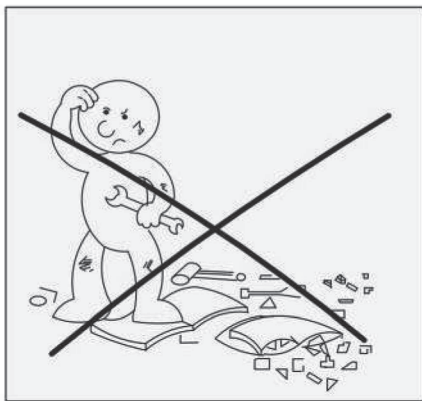
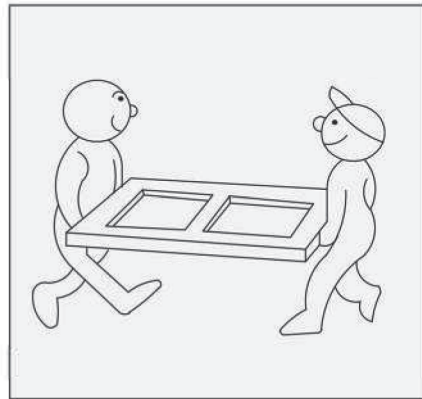
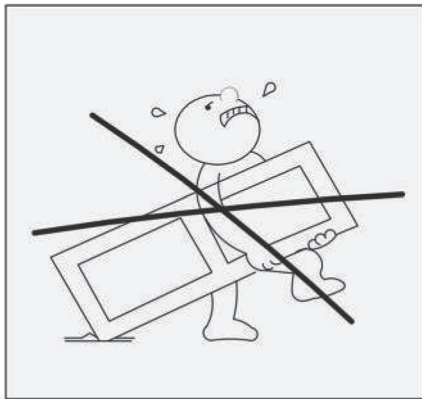
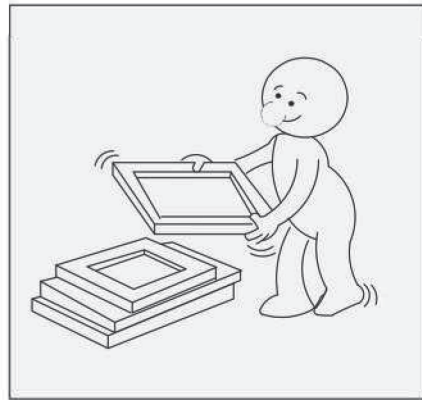
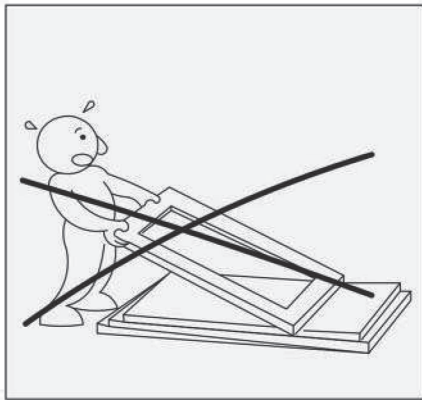
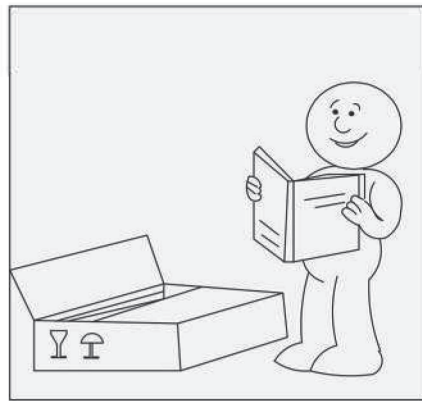
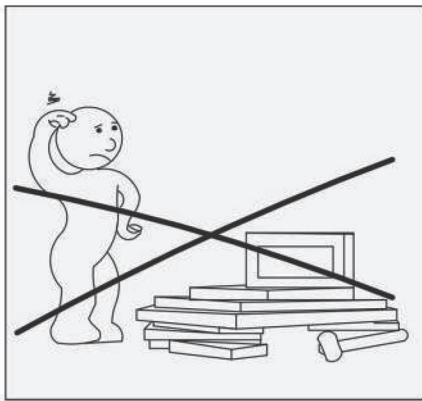

step 1

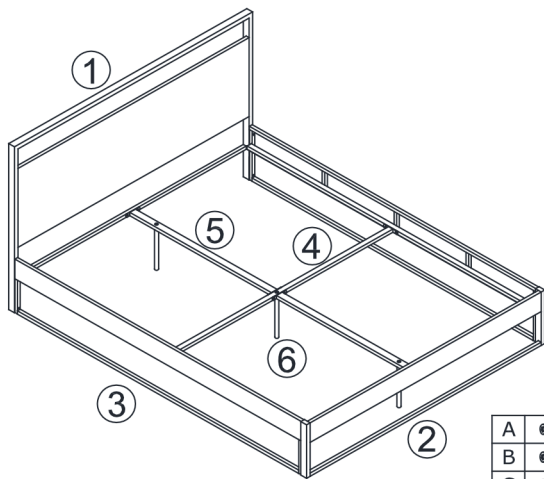

A		M6x40mm	x10
B		M6x30mm	x2
C		M6x15mm	x6
D		M6	x4
E		5MM	x1
F			x1
G		M6x15mm	x3
H		4MM	x1

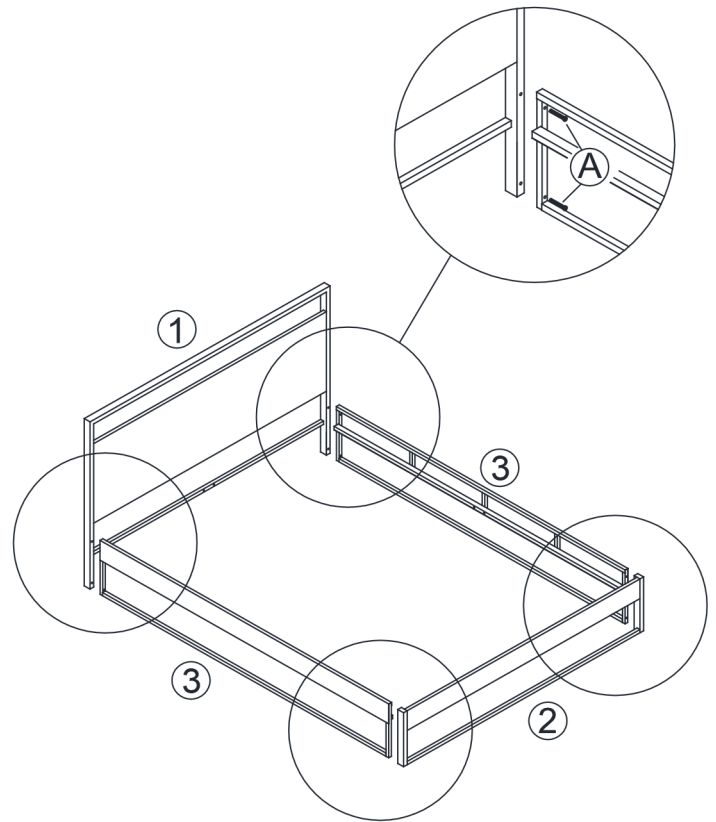
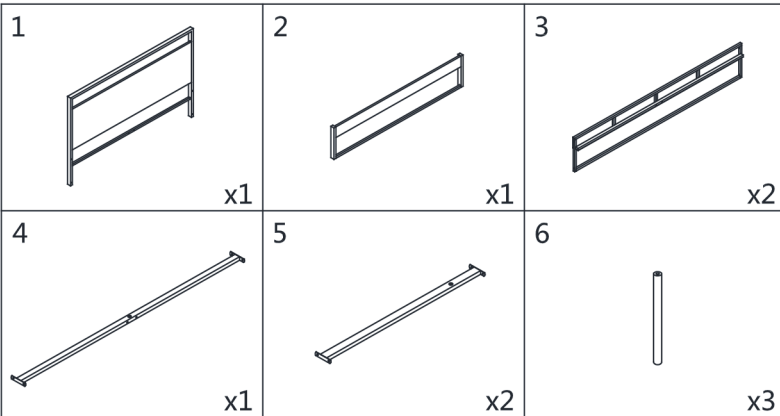

step 2

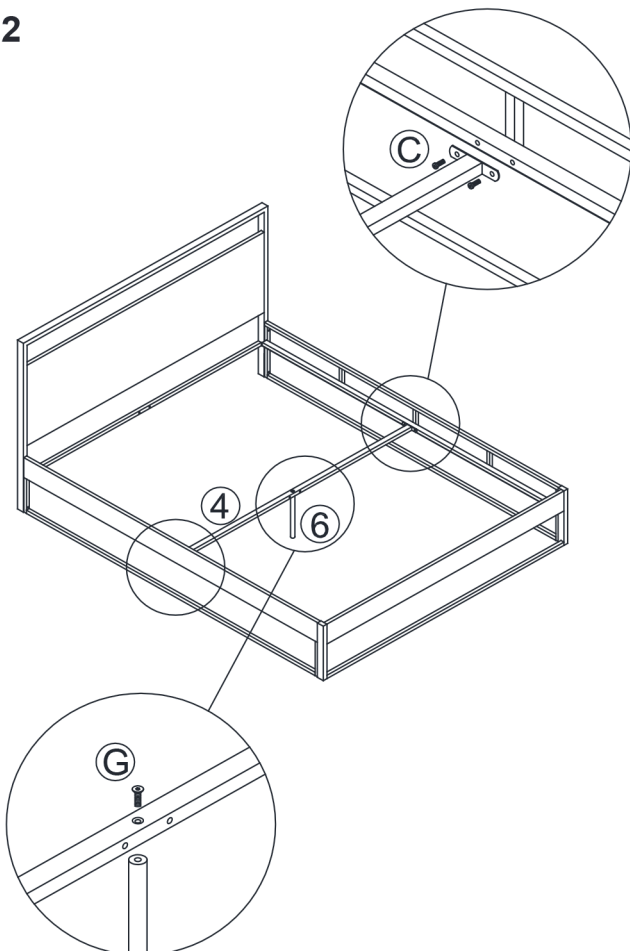

step 3

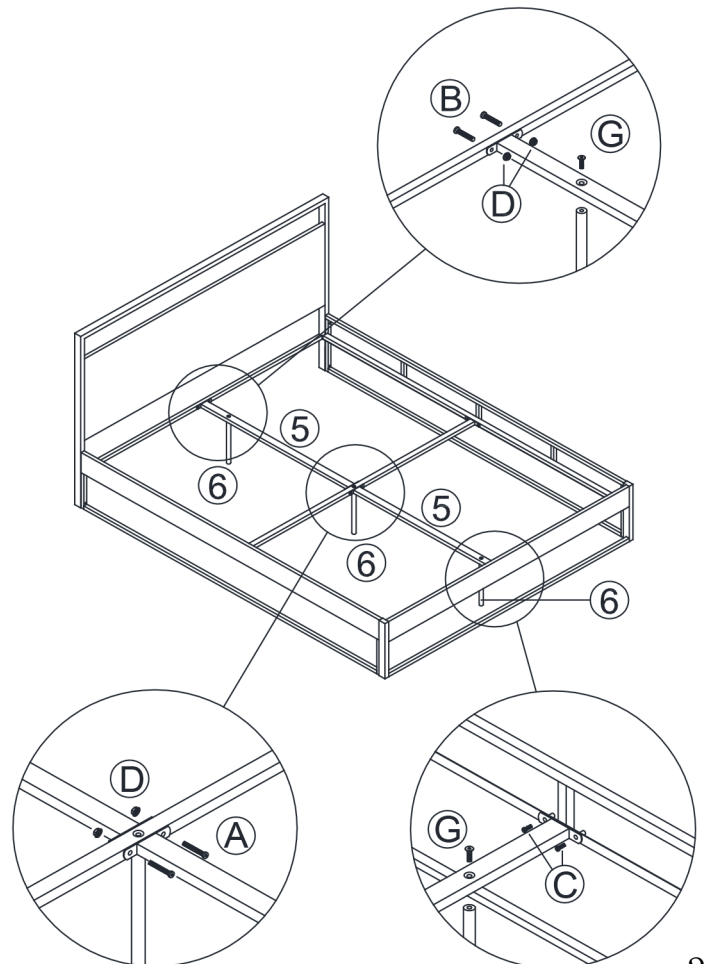

NL: Regelmatig schroeven controleren en eventueel aandraaien
 EN: Please check the screws regularly, tighten if necessary
 FR: S'il vous plaît vérifier les vis régulièrement, serrer si nécessaire
 DE: Bitte überprüfen Sie die Schrauben regelmäßig, ziehen Sie sie ggf. fest